



HADLEY HEIGHTS 2

OLYMPIC CHAMPION
EDITION

FLOOR PLANS



LEOS



FLOOR LEVELS

LEVEL 01

TYPICAL PLAN

- STUDIO
- 1-BEDROOM
- 2-BEDROOM
- 3-BEDROOM

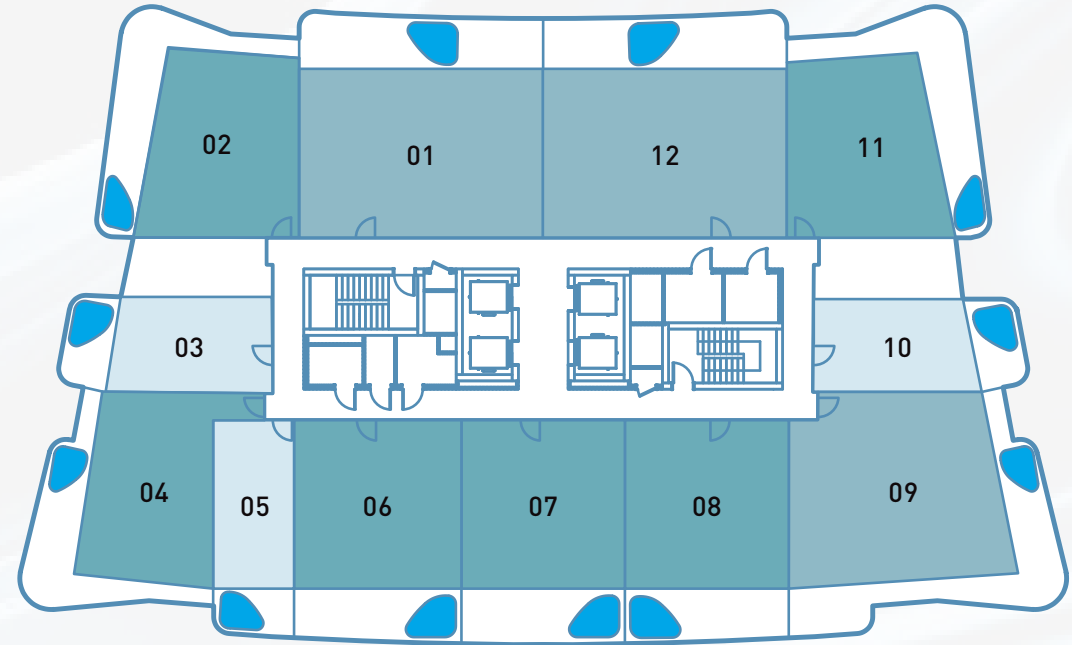

DISCLAIMER

All plans and 3D visualizations are based on conceptual design and are shown for illustration purposes only. Unit layouts are indicative, not to scale, and subject to change without prior notice. All dimensions, if shown, are approximate and exclude all wall finishes and construction tolerances. Furnishings & accessories shown are for representation only. The final built-up areas may vary from the official measurements issued by the 3rd party survey company accredited by the Dubai Land Department. The developer reserves the right to make any changes on any part of this document if & when they deem necessary.

LEVELS 2-3

TYPICAL PLAN

- STUDIO
- 1-BEDROOM
- 2-BEDROOM
- 3-BEDROOM

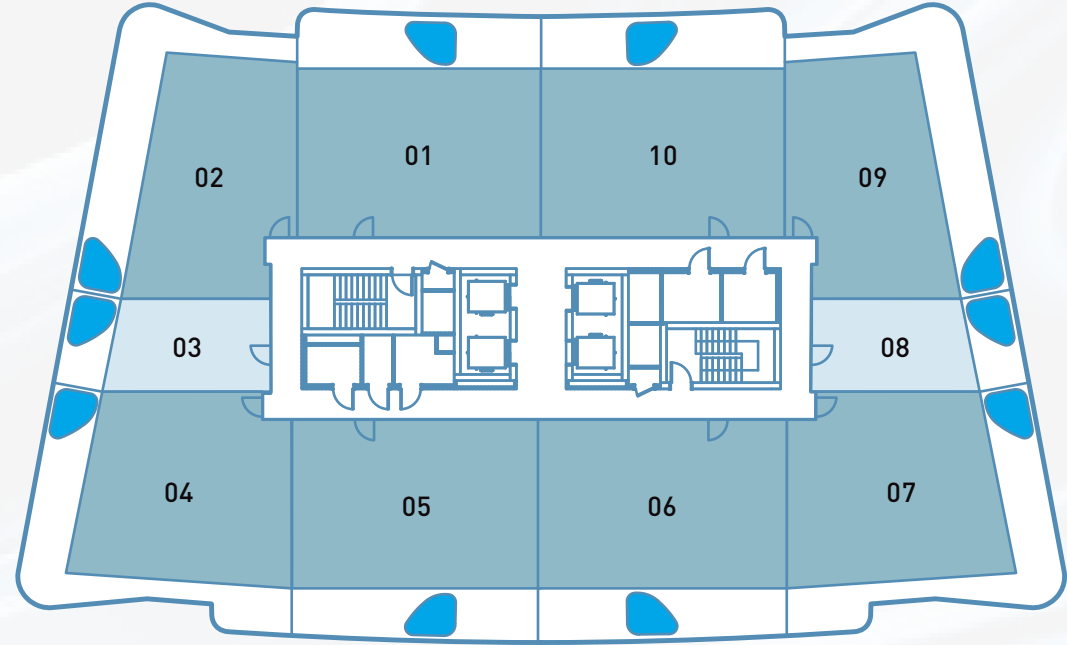

DISCLAIMER

All plans and 3D visualizations are based on conceptual design and are shown for illustration purposes only. Unit layouts are indicative, not to scale, and subject to change without prior notice. All dimensions, if shown, are approximate and exclude all wall finishes and construction tolerances. Furnishings & accessories shown are for representation only. The final built-up areas may vary from the official measurements issued by the 3rd party survey company accredited by the Dubai Land Department. The developer reserves the right to make any changes on any part of this document if & when they deem necessary.

LEVELS 4-7

TYPICAL PLAN

- STUDIO
- 1-BEDROOM
- 2-BEDROOM
- 3-BEDROOM

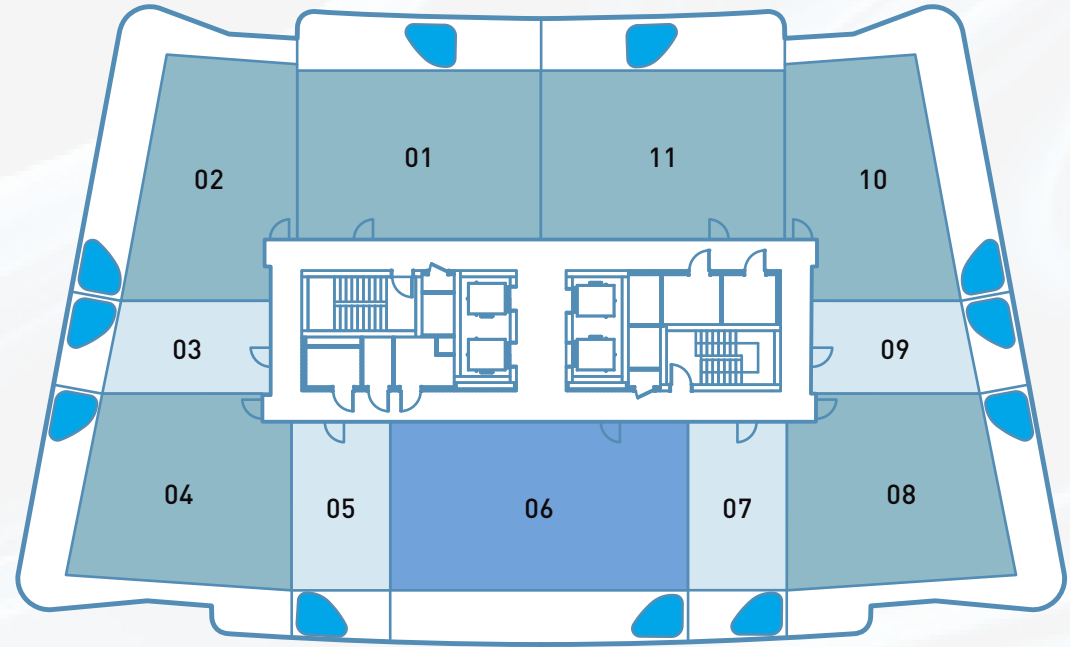

DISCLAIMER

All plans and 3D visualizations are based on conceptual design and are shown for illustration purposes only. Unit layouts are indicative, not to scale, and subject to change without prior notice. All dimensions, if shown, are approximate and exclude all wall finishes and construction tolerances. Furnishings & accessories shown are for representation only. The final built-up areas may vary from the official measurements issued by the 3rd party survey company accredited by the Dubai Land Department. The developer reserves the right to make any changes on any part of this document if & when they deem necessary.

LEVELS 8-12

TYPICAL PLAN

- STUDIO
- 1-BEDROOM
- 2-BEDROOM
- 3-BEDROOM

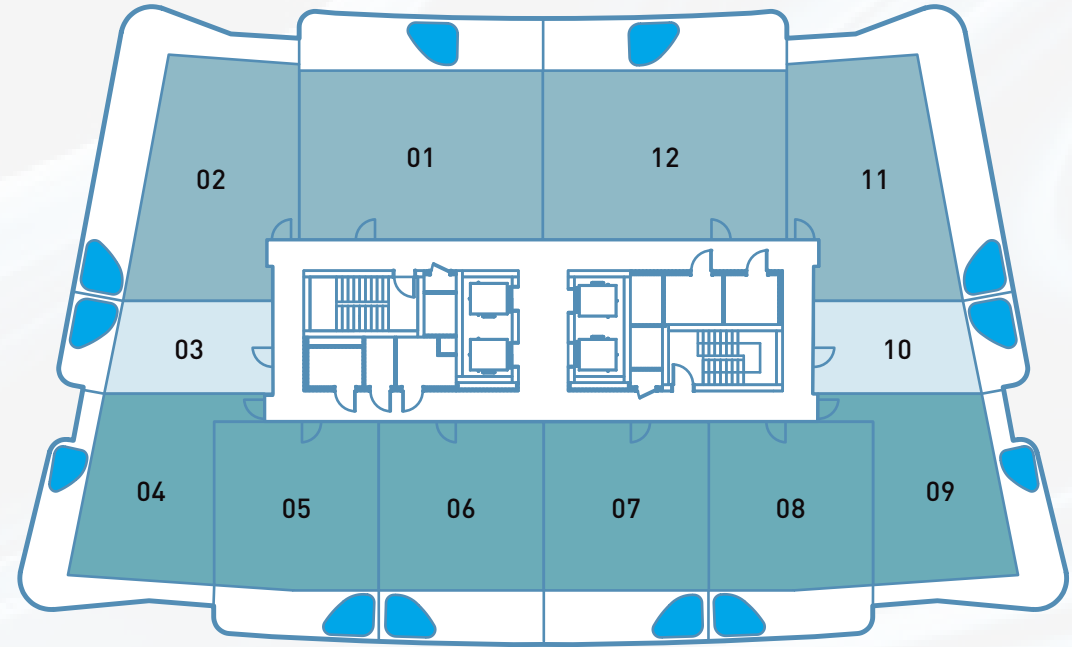

DISCLAIMER

All plans and 3D visualizations are based on conceptual design and are shown for illustration purposes only. Unit layouts are indicative, not to scale, and subject to change without prior notice. All dimensions, if shown, are approximate and exclude all wall finishes and construction tolerances. Furnishings & accessories shown are for representation only. The final built-up areas may vary from the official measurements issued by the 3rd party survey company accredited by the Dubai Land Department. The developer reserves the right to make any changes on any part of this document if & when they deem necessary.

LEVELS 13-16

TYPICAL PLAN

- STUDIO
- 1-BEDROOM
- 2-BEDROOM
- 3-BEDROOM

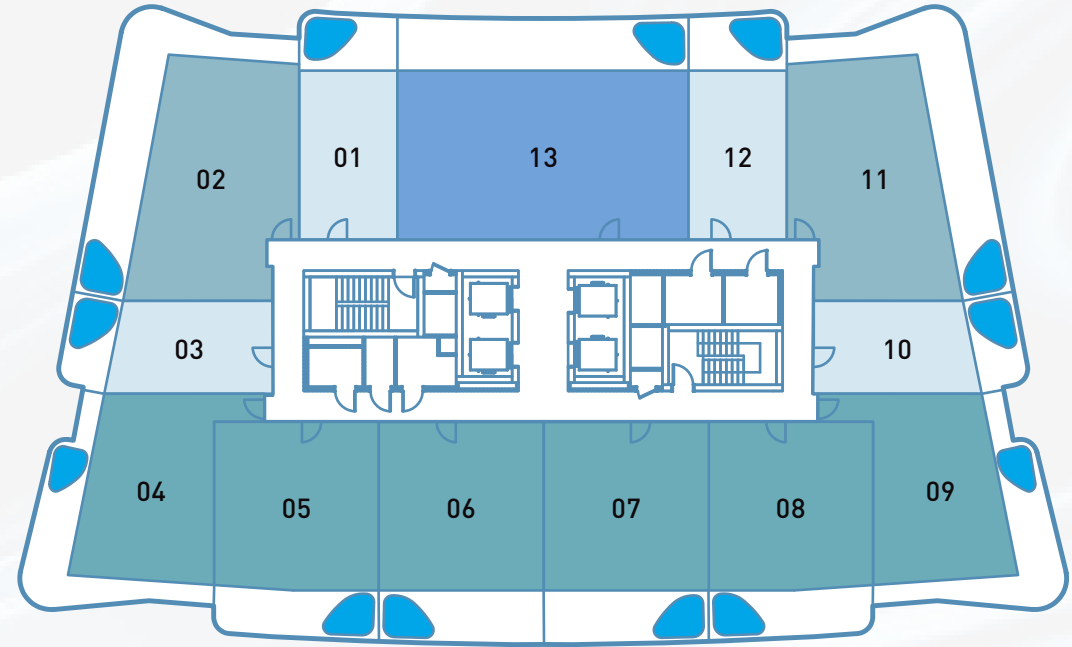

DISCLAIMER

All plans and 3D visualizations are based on conceptual design and are shown for illustration purposes only. Unit layouts are indicative, not to scale, and subject to change without prior notice. All dimensions, if shown, are approximate and exclude all wall finishes and construction tolerances. Furnishings & accessories shown are for representation only. The final built-up areas may vary from the official measurements issued by the 3rd party survey company accredited by the Dubai Land Department. The developer reserves the right to make any changes on any part of this document if & when they deem necessary.

LEVELS 17-19

TYPICAL PLAN

- STUDIO
- 1-BEDROOM
- 2-BEDROOM
- 3-BEDROOM

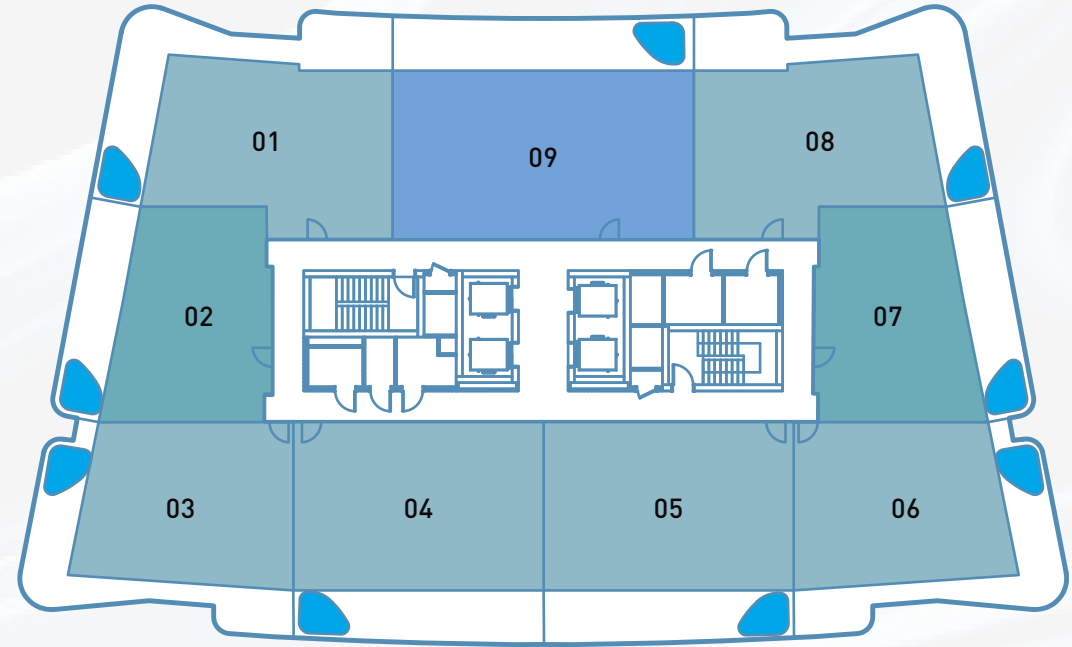

DISCLAIMER

All plans and 3D visualizations are based on conceptual design and are shown for illustration purposes only. Unit layouts are indicative, not to scale, and subject to change without prior notice. All dimensions, if shown, are approximate and exclude all wall finishes and construction tolerances. Furnishings & accessories shown are for representation only. The final built-up areas may vary from the official measurements issued by the 3rd party survey company accredited by the Dubai Land Department. The developer reserves the right to make any changes on any part of this document if & when they deem necessary.

LEVEL 20

TYPICAL PLAN

- STUDIO
- 1-BEDROOM
- 2-BEDROOM
- 3-BEDROOM

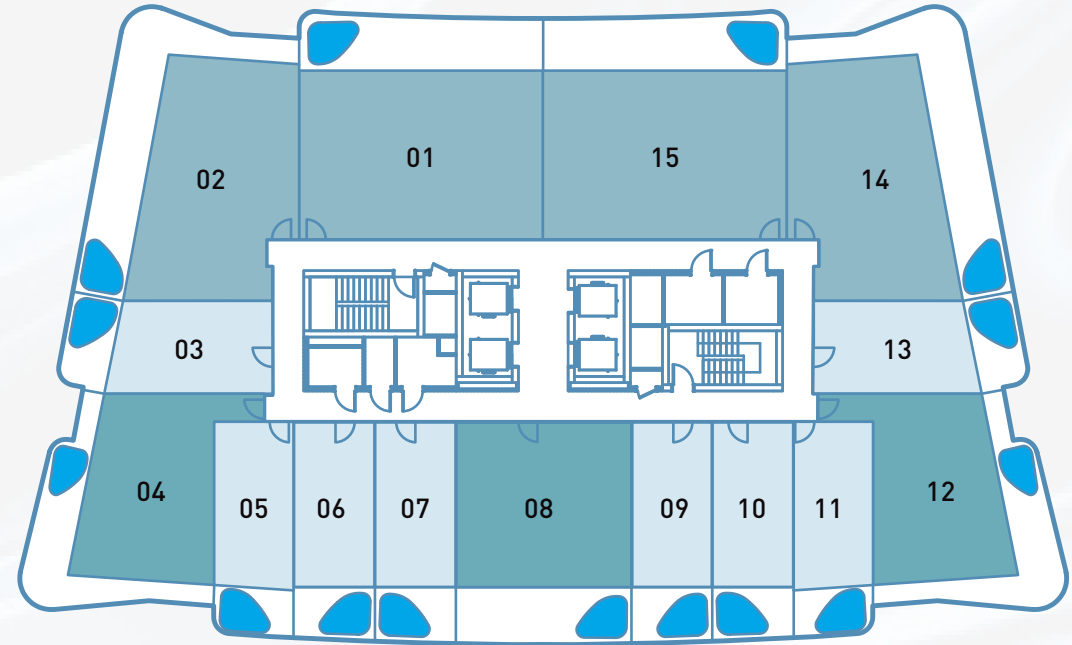

DISCLAIMER

All plans and 3D visualizations are based on conceptual design and are shown for illustration purposes only. Unit layouts are indicative, not to scale, and subject to change without prior notice. All dimensions, if shown, are approximate and exclude all wall finishes and construction tolerances. Furnishings & accessories shown are for representation only. The final built-up areas may vary from the official measurements issued by the 3rd party survey company accredited by the Dubai Land Department. The developer reserves the right to make any changes on any part of this document if & when they deem necessary.

FLOOR PLANS



STUDIO APARTMENTS

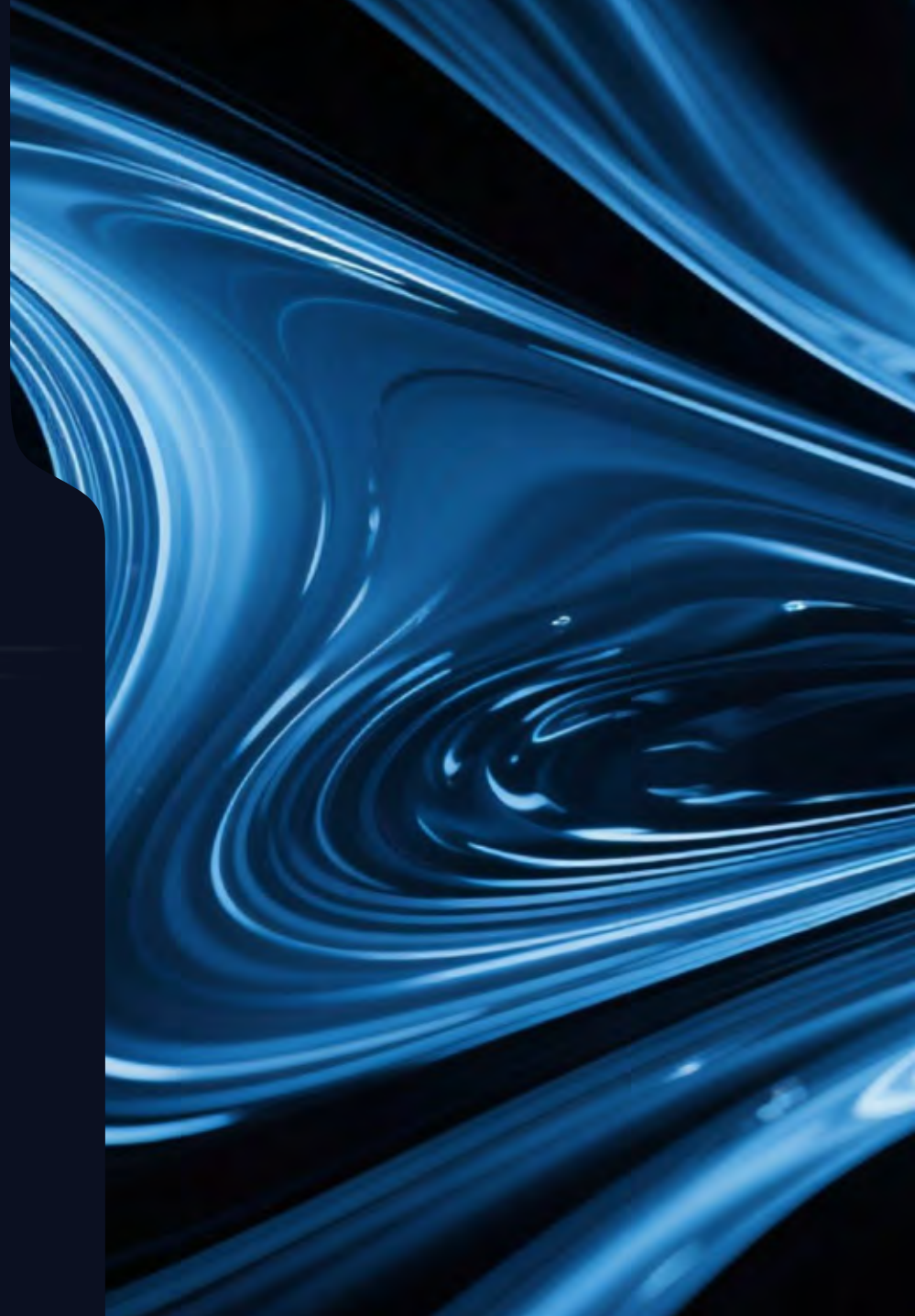

STUDIO

UNIT 103 | TYPICAL UNIT TYPE 01A

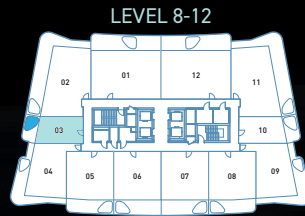
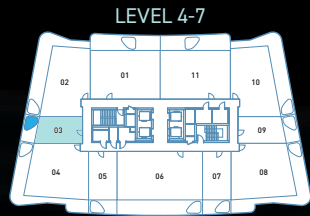

TOTAL AREA

453.16 sq.ft.

TOTAL INTERNAL AREA

355.64 sq.ft.

TOTAL EXTERNAL AREA

97.52 sq.ft.



DISCLAIMER

All plans and 3D visualizations are based on conceptual design and are shown for illustration purposes only. Unit layouts are indicative, not to scale, and subject to change without prior notice. All dimensions, if shown, are approximate and exclude all wall finishes and construction tolerances. Furnishings & accessories shown are for representation only. The final built-up areas may vary from the official measurements issued by the 3rd party survey company accredited by the Dubai Land Department. The developer reserves the right to make any changes on any part of this document if & when they deem necessary.

STUDIO

UNIT 110 | TYPICAL UNIT TYPE 01B

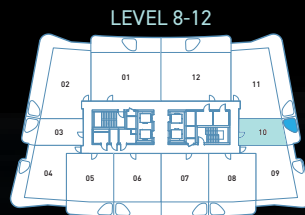
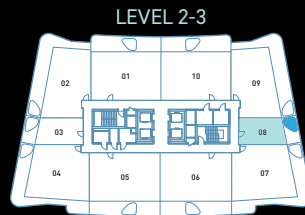

TOTAL AREA

454.24 sq.ft.

TOTAL INTERNAL AREA

355.75 sq.ft.

TOTAL EXTERNAL AREA

98.49 sq.ft.



DISCLAIMER

All plans and 3D visualizations are based on conceptual design and are shown for illustration purposes only. Unit layouts are indicative, not to scale, and subject to change without prior notice. All dimensions, if shown, are approximate and exclude all wall finishes and construction tolerances. Furnishings & accessories shown are for representation only. The final built-up areas may vary from the official measurements issued by the 3rd party survey company accredited by the Dubai Land Department. The developer reserves the right to make any changes on any part of this document if & when they deem necessary.

STUDIO

UNIT 105 | TYPICAL UNIT TYPE 02A

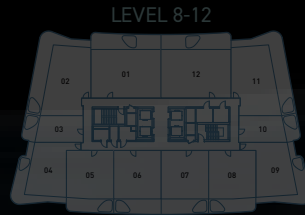
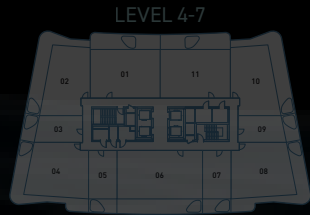

TOTAL AREA

422.05 sq.ft.

TOTAL INTERNAL AREA

329.70 sq.ft.

TOTAL EXTERNAL AREA

92.35 sq.ft.



DISCLAIMER

All plans and 3D visualizations are based on conceptual design and are shown for illustration purposes only. Unit layouts are indicative, not to scale, and subject to change without prior notice. All dimensions, if shown, are approximate and exclude all wall finishes and construction tolerances. Furnishings & accessories shown are for representation only. The final built-up areas may vary from the official measurements issued by the 3rd party survey company accredited by the Dubai Land Department. The developer reserves the right to make any changes on any part of this document if & when they deem necessary.

STUDIO

UNIT 2011 | UNIT TYPE 02B

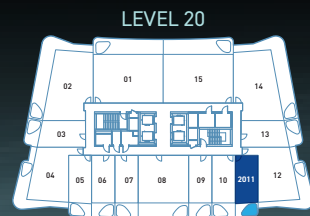
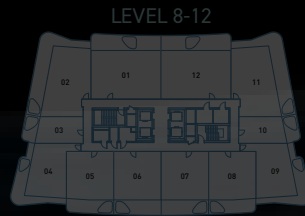
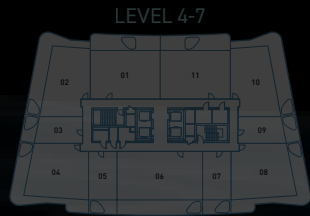

TOTAL AREA

423.02 sq.ft.

TOTAL INTERNAL AREA

330.45 sq.ft.

TOTAL EXTERNAL AREA

92.57 sq.ft.

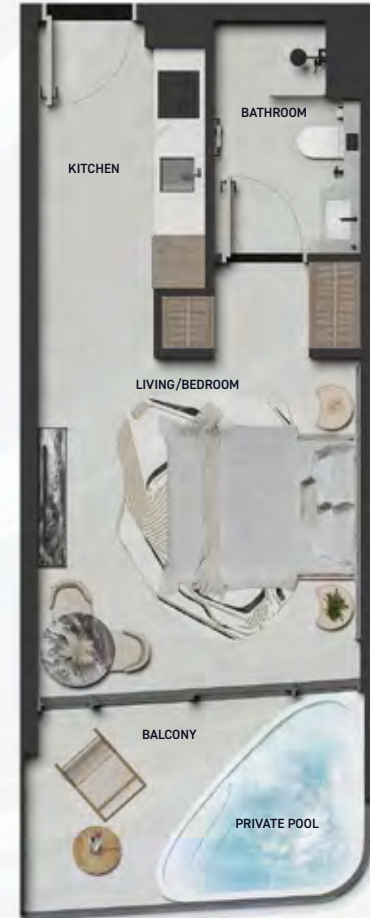

DISCLAIMER

All plans and 3D visualizations are based on conceptual design and are shown for illustration purposes only. Unit layouts are indicative, not to scale, and subject to change without prior notice. All dimensions, if shown, are approximate and exclude all wall finishes and construction tolerances. Furnishings & accessories shown are for representation only. The final built-up areas may vary from the official measurements issued by the 3rd party survey company accredited by the Dubai Land Department. The developer reserves the right to make any changes on any part of this document if & when they deem necessary.

STUDIO

UNIT 407 | TYPICAL UNIT TYPE 03A

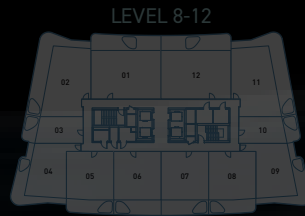
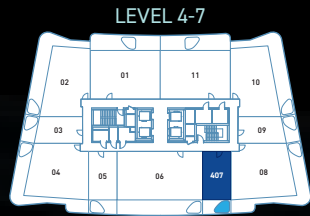

TOTAL AREA

510.64 sq.ft.

TOTAL INTERNAL AREA

383.09 sq.ft.

TOTAL EXTERNAL AREA

127.55 sq.ft.



DISCLAIMER

All plans and 3D visualizations are based on conceptual design and are shown for illustration purposes only. Unit layouts are indicative, not to scale, and subject to change without prior notice. All dimensions, if shown, are approximate and exclude all wall finishes and construction tolerances. Furnishings & accessories shown are for representation only. The final built-up areas may vary from the official measurements issued by the 3rd party survey company accredited by the Dubai Land Department. The developer reserves the right to make any changes on any part of this document if & when they deem necessary.

STUDIO

UNIT 405 | TYPICAL UNIT TYPE 03B

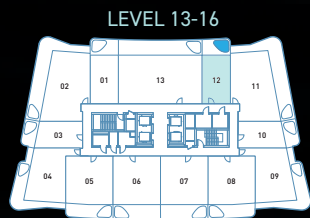
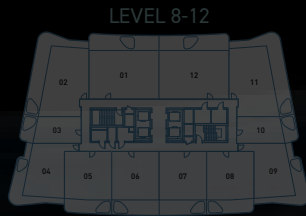

TOTAL AREA

511.18 sq.ft.

TOTAL INTERNAL AREA

383.09 sq.ft.

TOTAL EXTERNAL AREA

128.09 sq.ft.

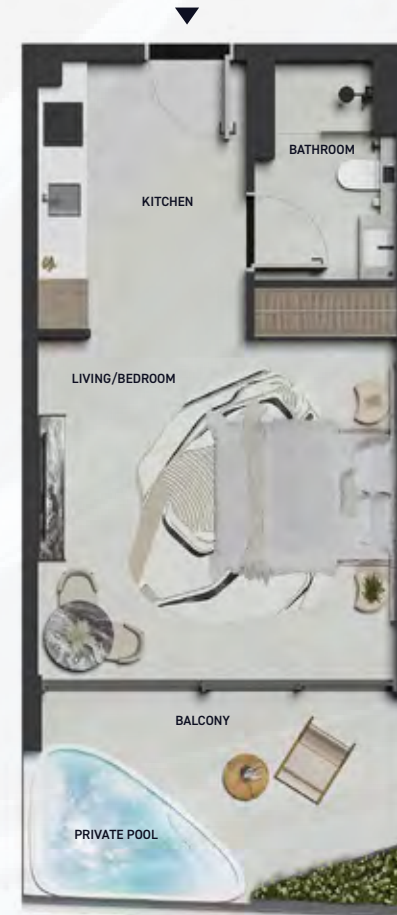

DISCLAIMER

All plans and 3D visualizations are based on conceptual design and are shown for illustration purposes only. Unit layouts are indicative, not to scale, and subject to change without prior notice. All dimensions, if shown, are approximate and exclude all wall finishes and construction tolerances. Furnishings & accessories shown are for representation only. The final built-up areas may vary from the official measurements issued by the 3rd party survey company accredited by the Dubai Land Department. The developer reserves the right to make any changes on any part of this document if & when they deem necessary.

1-BEDROOM APARTMENTS



1-BEDROOM

UNIT 102 | UNIT TYPE 01A

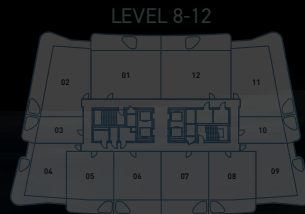
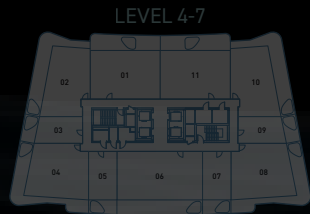
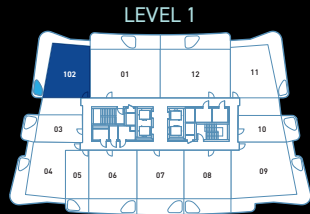

TOTAL AREA

947.33 sq.ft.

TOTAL INTERNAL AREA

655.63 sq.ft.

TOTAL EXTERNAL AREA

291.70 sq.ft.



DISCLAIMER

All plans and 3D visualizations are based on conceptual design and are shown for illustration purposes only. Unit layouts are indicative, not to scale, and subject to change without prior notice. All dimensions, if shown, are approximate and exclude all wall finishes and construction tolerances. Furnishings & accessories shown are for representation only. The final built-up areas may vary from the official measurements issued by the 3rd party survey company accredited by the Dubai Land Department. The developer reserves the right to make any changes on any part of this document if & when they deem necessary.

1-BEDROOM

UNIT 111 | UNIT TYPE 01B

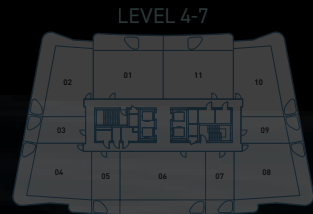
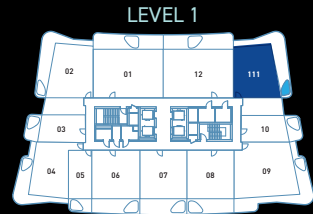

TOTAL AREA

948.19 sq.ft.

TOTAL INTERNAL AREA

656.92 sq.ft.

TOTAL EXTERNAL AREA

291.27 sq.ft.



DISCLAIMER

All plans and 3D visualizations are based on conceptual design and are shown for illustration purposes only. Unit layouts are indicative, not to scale, and subject to change without prior notice. All dimensions, if shown, are approximate and exclude all wall finishes and construction tolerances. Furnishings & accessories shown are for representation only. The final built-up areas may vary from the official measurements issued by the 3rd party survey company accredited by the Dubai Land Department. The developer reserves the right to make any changes on any part of this document if & when they deem necessary.

1-BEDROOM

UNIT 104 | TYPICAL UNIT TYPE 02A

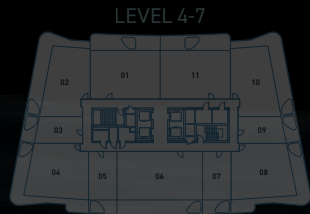
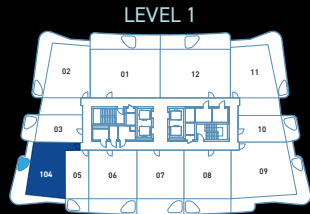

TOTAL AREA

911.27 sq.ft.

TOTAL INTERNAL AREA

630.66 sq.ft.

TOTAL EXTERNAL AREA

280.62 sq.ft.



DISCLAIMER

All plans and 3D visualizations are based on conceptual design and are shown for illustration purposes only. Unit layouts are indicative, not to scale, and subject to change without prior notice. All dimensions, if shown, are approximate and exclude all wall finishes and construction tolerances. Furnishings & accessories shown are for representation only. The final built-up areas may vary from the official measurements issued by the 3rd party survey company accredited by the Dubai Land Department. The developer reserves the right to make any changes on any part of this document if & when they deem necessary.

1-BEDROOM

UNIT 809 | TYPICAL UNIT TYPE 02B

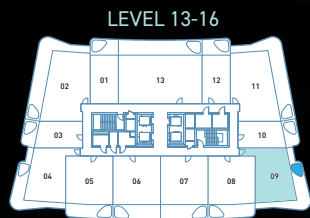
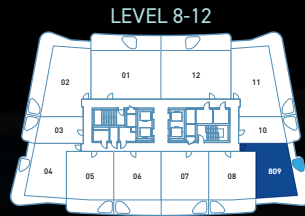
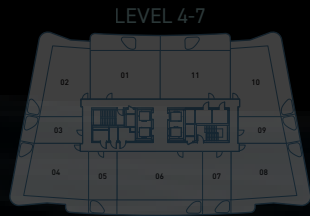

TOTAL AREA

910.73 sq.ft.

TOTAL INTERNAL AREA

629.90 sq.ft.

TOTAL EXTERNAL AREA

280.83 sq.ft.



DISCLAIMER

All plans and 3D visualizations are based on conceptual design and are shown for illustration purposes only. Unit layouts are indicative, not to scale, and subject to change without prior notice. All dimensions, if shown, are approximate and exclude all wall finishes and construction tolerances. Furnishings & accessories shown are for representation only. The final built-up areas may vary from the official measurements issued by the 3rd party survey company accredited by the Dubai Land Department. The developer reserves the right to make any changes on any part of this document if & when they deem necessary.

1-BEDROOM

UNIT 106 | TYPICAL UNIT TYPE 03A

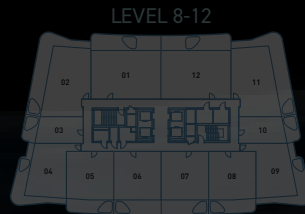
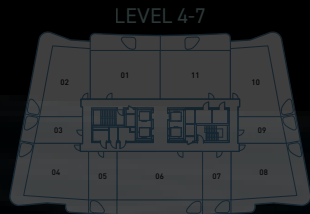

TOTAL AREA

880.38 sq.ft.

TOTAL INTERNAL AREA

656.60 sq.ft.

TOTAL EXTERNAL AREA

223.78 sq.ft.



DISCLAIMER

All plans and 3D visualizations are based on conceptual design and are shown for illustration purposes only. Unit layouts are indicative, not to scale, and subject to change without prior notice. All dimensions, if shown, are approximate and exclude all wall finishes and construction tolerances. Furnishings & accessories shown are for representation only. The final built-up areas may vary from the official measurements issued by the 3rd party survey company accredited by the Dubai Land Department. The developer reserves the right to make any changes on any part of this document if & when they deem necessary.

1-BEDROOM

UNIT 108 | UNIT TYPE 03B

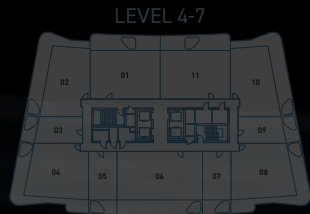

TOTAL AREA

879.30 sq.ft.

TOTAL INTERNAL AREA

655.41 sq.ft.

TOTAL EXTERNAL AREA

223.89 sq.ft.



DISCLAIMER

All plans and 3D visualizations are based on conceptual design and are shown for illustration purposes only. Unit layouts are indicative, not to scale, and subject to change without prior notice. All dimensions, if shown, are approximate and exclude all wall finishes and construction tolerances. Furnishings & accessories shown are for representation only. The final built-up areas may vary from the official measurements issued by the 3rd party survey company accredited by the Dubai Land Department. The developer reserves the right to make any changes on any part of this document if & when they deem necessary.

1-BEDROOM

UNIT 805 | TYPICAL UNIT TYPE 04A

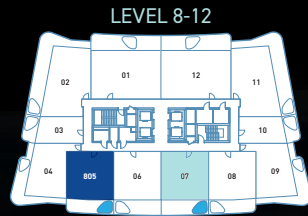
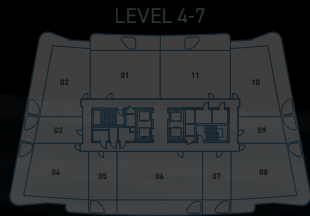

TOTAL AREA

858.21 sq.ft.

TOTAL INTERNAL AREA

657.14 sq.ft.

TOTAL EXTERNAL AREA

201.07 sq.ft.



DISCLAIMER

All plans and 3D visualizations are based on conceptual design and are shown for illustration purposes only. Unit layouts are indicative, not to scale, and subject to change without prior notice. All dimensions, if shown, are approximate and exclude all wall finishes and construction tolerances. Furnishings & accessories shown are for representation only. The final built-up areas may vary from the official measurements issued by the 3rd party survey company accredited by the Dubai Land Department. The developer reserves the right to make any changes on any part of this document if & when they deem necessary.

1-BEDROOM

UNIT 806 | TYPICAL UNIT TYPE 04B

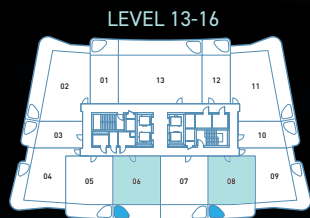

TOTAL AREA

888.56 sq.ft.

TOTAL INTERNAL AREA

655.41 sq.ft.

TOTAL EXTERNAL AREA

233.15 sq.ft.



DISCLAIMER

All plans and 3D visualizations are based on conceptual design and are shown for illustration purposes only. Unit layouts are indicative, not to scale, and subject to change without prior notice. All dimensions, if shown, are approximate and exclude all wall finishes and construction tolerances. Furnishings & accessories shown are for representation only. The final built-up areas may vary from the official measurements issued by the 3rd party survey company accredited by the Dubai Land Department. The developer reserves the right to make any changes on any part of this document if & when they deem necessary.

1-BEDROOM

UNIT 1702 | TYPICAL UNIT TYPE 05A

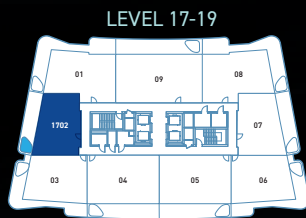
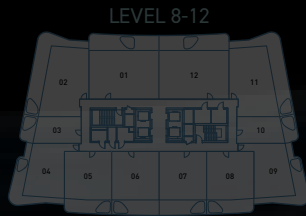
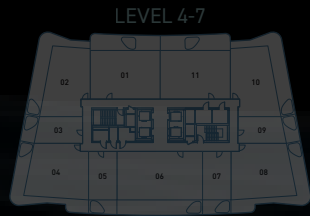

TOTAL AREA

1,038.61 sq.ft.

TOTAL INTERNAL AREA

794.38 sq.ft.

TOTAL EXTERNAL AREA

244.23 sq.ft.



DISCLAIMER

All plans and 3D visualizations are based on conceptual design and are shown for illustration purposes only. Unit layouts are indicative, not to scale, and subject to change without prior notice. All dimensions, if shown, are approximate and exclude all wall finishes and construction tolerances. Furnishings & accessories shown are for representation only. The final built-up areas may vary from the official measurements issued by the 3rd party survey company accredited by the Dubai Land Department. The developer reserves the right to make any changes on any part of this document if & when they deem necessary.

1-BEDROOM

UNIT 1707 | TYPICAL UNIT TYPE 05B

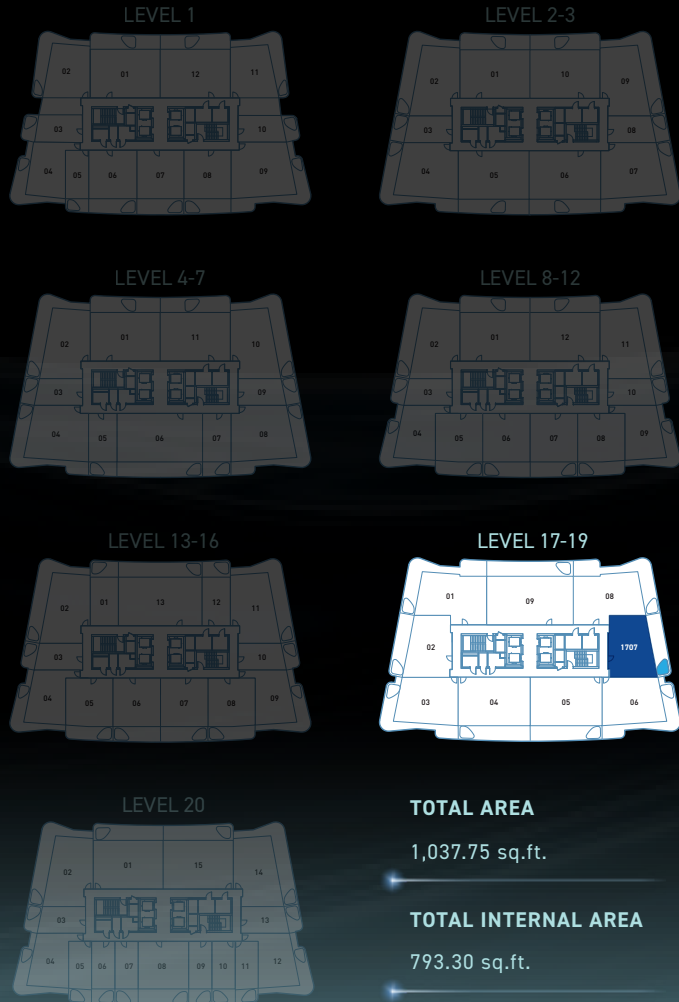

TOTAL AREA

1,037.75 sq.ft.

TOTAL INTERNAL AREA

793.30 sq.ft.

TOTAL EXTERNAL AREA

244.45 sq.ft.



DISCLAIMER

All plans and 3D visualizations are based on conceptual design and are shown for illustration purposes only. Unit layouts are indicative, not to scale, and subject to change without prior notice. All dimensions, if shown, are approximate and exclude all wall finishes and construction tolerances. Furnishings & accessories shown are for representation only. The final built-up areas may vary from the official measurements issued by the 3rd party survey company accredited by the Dubai Land Department. The developer reserves the right to make any changes on any part of this document if & when they deem necessary.

2-BEDROOM APARTMENTS

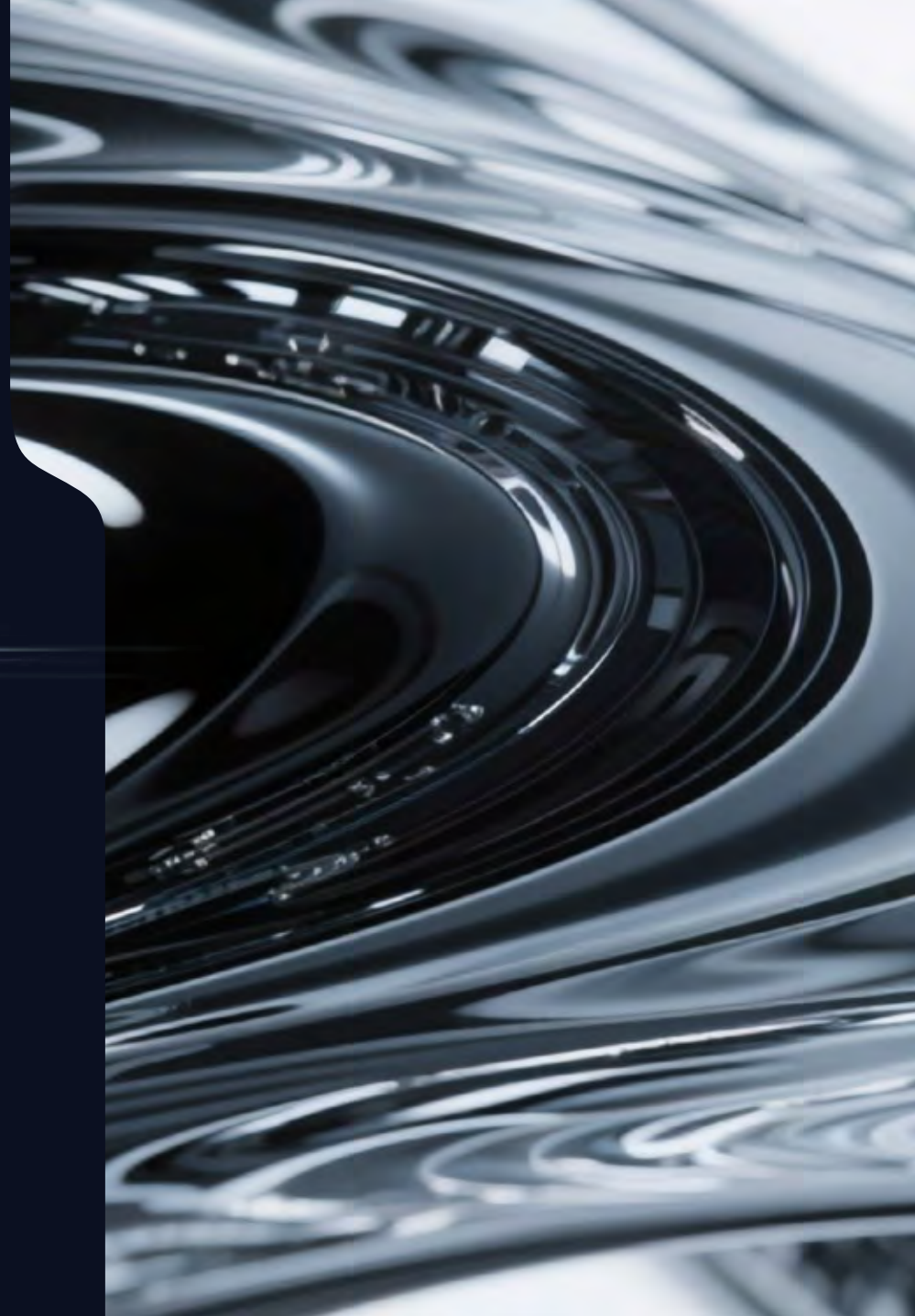

2-BEDROOM

UNIT 101 | TYPICAL UNIT TYPE 01A

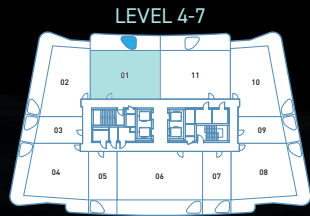
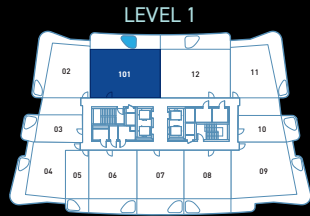

TOTAL AREA

1,310.61 sq.ft.

TOTAL INTERNAL AREA

1,018.59 sq.ft.

TOTAL EXTERNAL AREA

292.02 sq.ft.



DISCLAIMER

All plans and 3D visualizations are based on conceptual design and are shown for illustration purposes only. Unit layouts are indicative, not to scale, and subject to change without prior notice. All dimensions, if shown, are approximate and exclude all wall finishes and construction tolerances. Furnishings & accessories shown are for representation only. The final built-up areas may vary from the official measurements issued by the 3rd party survey company accredited by the Dubai Land Department. The developer reserves the right to make any changes on any part of this document if & when they deem necessary.

2-BEDROOM

UNIT 2001 | TYPICAL UNIT TYPE 01AA

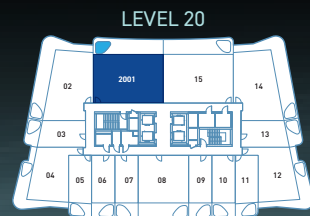
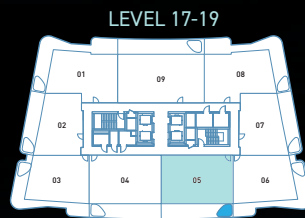
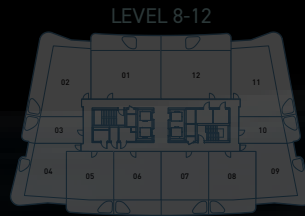
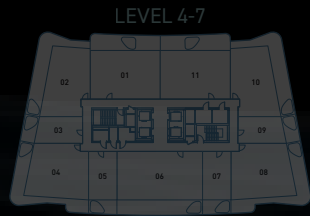

TOTAL AREA

1,309.54 sq.ft.

TOTAL INTERNAL AREA

1,017.51 sq.ft.

TOTAL EXTERNAL AREA

292.02 sq.ft.



DISCLAIMER

All plans and 3D visualizations are based on conceptual design and are shown for illustration purposes only. Unit layouts are indicative, not to scale, and subject to change without prior notice. All dimensions, if shown, are approximate and exclude all wall finishes and construction tolerances. Furnishings & accessories shown are for representation only. The final built-up areas may vary from the official measurements issued by the 3rd party survey company accredited by the Dubai Land Department. The developer reserves the right to make any changes on any part of this document if & when they deem necessary.

2-BEDROOM

UNIT 112 | TYPICAL UNIT TYPE 01B

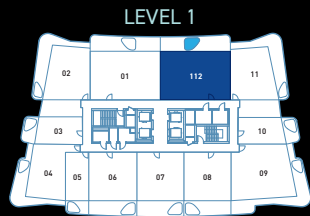

TOTAL AREA

1,310.51 sq.ft.

TOTAL INTERNAL AREA

1,018.70 sq.ft.

TOTAL EXTERNAL AREA

291.81 sq.ft.



DISCLAIMER

All plans and 3D visualizations are based on conceptual design and are shown for illustration purposes only. Unit layouts are indicative, not to scale, and subject to change without prior notice. All dimensions, if shown, are approximate and exclude all wall finishes and construction tolerances. Furnishings & accessories shown are for representation only. The final built-up areas may vary from the official measurements issued by the 3rd party survey company accredited by the Dubai Land Department. The developer reserves the right to make any changes on any part of this document if & when they deem necessary.

2-BEDROOM

UNIT 2015 | TYPICAL UNIT TYPE 01BB

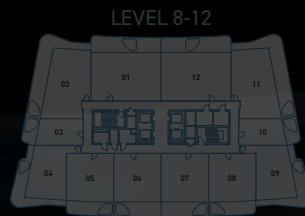
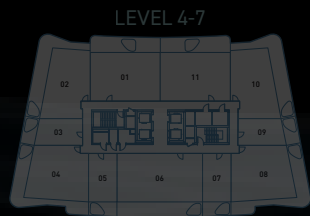

TOTAL AREA

1,309.32 sq.ft.

TOTAL INTERNAL AREA

1,017.51 sq.ft.

TOTAL EXTERNAL AREA

291.81 sq.ft.



DISCLAIMER

All plans and 3D visualizations are based on conceptual design and are shown for illustration purposes only. Unit layouts are indicative, not to scale, and subject to change without prior notice. All dimensions, if shown, are approximate and exclude all wall finishes and construction tolerances. Furnishings & accessories shown are for representation only. The final built-up areas may vary from the official measurements issued by the 3rd party survey company accredited by the Dubai Land Department. The developer reserves the right to make any changes on any part of this document if & when they deem necessary.

2-BEDROOM

UNIT 204 | TYPICAL UNIT TYPE 02A



TOTAL AREA

1,389.73 sq.ft.

TOTAL INTERNAL AREA

963.15 sq.ft.

TOTAL EXTERNAL AREA

426.57 sq.ft.



DISCLAIMER

All plans and 3D visualizations are based on conceptual design and are shown for illustration purposes only. Unit layouts are indicative, not to scale, and subject to change without prior notice. All dimensions, if shown, are approximate and exclude all wall finishes and construction tolerances. Furnishings & accessories shown are for representation only. The final built-up areas may vary from the official measurements issued by the 3rd party survey company accredited by the Dubai Land Department. The developer reserves the right to make any changes on any part of this document if & when they deem necessary.

2-BEDROOM

UNIT 109 | TYPICAL UNIT TYPE 02B

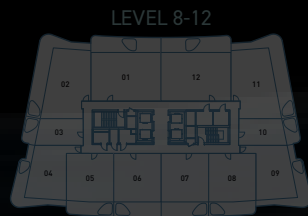
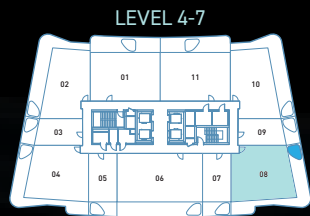
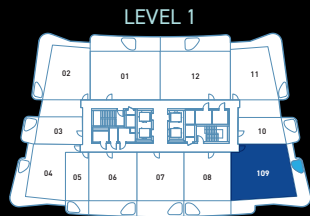

TOTAL AREA

1,335.80 sq.ft.

TOTAL INTERNAL AREA

962.83 sq.ft.

TOTAL EXTERNAL AREA

372.97 sq.ft.



DISCLAIMER

All plans and 3D visualizations are based on conceptual design and are shown for illustration purposes only. Unit layouts are indicative, not to scale, and subject to change without prior notice. All dimensions, if shown, are approximate and exclude all wall finishes and construction tolerances. Furnishings & accessories shown are for representation only. The final built-up areas may vary from the official measurements issued by the 3rd party survey company accredited by the Dubai Land Department. The developer reserves the right to make any changes on any part of this document if & when they deem necessary.

2-BEDROOM

UNIT 202 | TYPICAL UNIT TYPE 03A

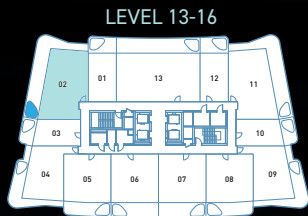

TOTAL AREA

1,266.48 sq.ft.

TOTAL INTERNAL AREA

878.34 sq.ft.

TOTAL EXTERNAL AREA

388.15 sq.ft.



DISCLAIMER

All plans and 3D visualizations are based on conceptual design and are shown for illustration purposes only. Unit layouts are indicative, not to scale, and subject to change without prior notice. All dimensions, if shown, are approximate and exclude all wall finishes and construction tolerances. Furnishings & accessories shown are for representation only. The final built-up areas may vary from the official measurements issued by the 3rd party survey company accredited by the Dubai Land Department. The developer reserves the right to make any changes on any part of this document if & when they deem necessary.

2-BEDROOM

UNIT 209 | TYPICAL UNIT TYPE 03B

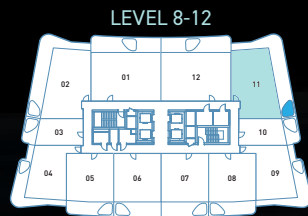
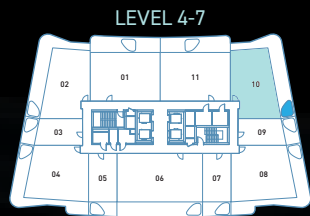
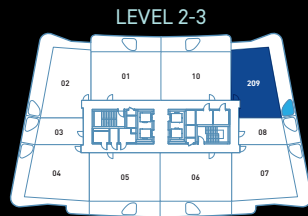

TOTAL AREA

1,265.73 sq.ft.

TOTAL INTERNAL AREA

878.98 sq.ft.

TOTAL EXTERNAL AREA

386.75 sq.ft.



DISCLAIMER

All plans and 3D visualizations are based on conceptual design and are shown for illustration purposes only. Unit layouts are indicative, not to scale, and subject to change without prior notice. All dimensions, if shown, are approximate and exclude all wall finishes and construction tolerances. Furnishings & accessories shown are for representation only. The final built-up areas may vary from the official measurements issued by the 3rd party survey company accredited by the Dubai Land Department. The developer reserves the right to make any changes on any part of this document if & when they deem necessary.

2-BEDROOM

UNIT 1701 | TYPICAL UNIT TYPE 04A

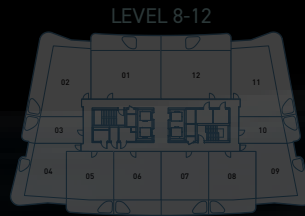
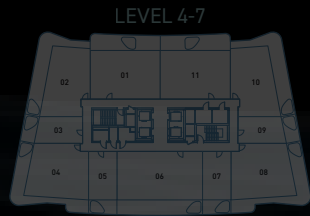

TOTAL AREA

1,351.52 sq.ft.

TOTAL INTERNAL AREA

949.92 sq.ft.

TOTAL EXTERNAL AREA

401.60 sq.ft.



DISCLAIMER

All plans and 3D visualizations are based on conceptual design and are shown for illustration purposes only. Unit layouts are indicative, not to scale, and subject to change without prior notice. All dimensions, if shown, are approximate and exclude all wall finishes and construction tolerances. Furnishings & accessories shown are for representation only. The final built-up areas may vary from the official measurements issued by the 3rd party survey company accredited by the Dubai Land Department. The developer reserves the right to make any changes on any part of this document if & when they deem necessary.

2-BEDROOM

UNIT 1708 | TYPICAL UNIT TYPE 04B

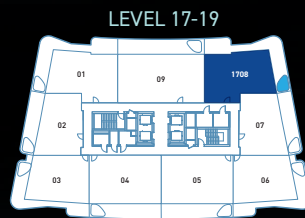
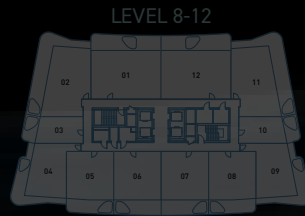
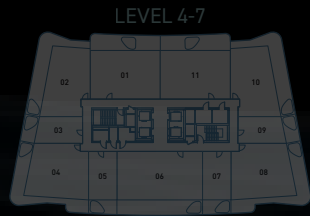

TOTAL AREA

1,353.88 sq.ft.

TOTAL INTERNAL AREA

953.25 sq.ft.

TOTAL EXTERNAL AREA

400.63 sq.ft.



DISCLAIMER

All plans and 3D visualizations are based on conceptual design and are shown for illustration purposes only. Unit layouts are indicative, not to scale, and subject to change without prior notice. All dimensions, if shown, are approximate and exclude all wall finishes and construction tolerances. Furnishings & accessories shown are for representation only. The final built-up areas may vary from the official measurements issued by the 3rd party survey company accredited by the Dubai Land Department. The developer reserves the right to make any changes on any part of this document if & when they deem necessary.

2-BEDROOM

UNIT 1703 | TYPICAL UNIT TYPE 05A

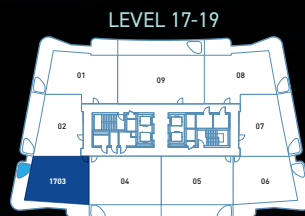

TOTAL AREA

1,208.89 sq.ft.

TOTAL INTERNAL AREA

837.97 sq.ft.

TOTAL EXTERNAL AREA

370.92 sq.ft.



DISCLAIMER

All plans and 3D visualizations are based on conceptual design and are shown for illustration purposes only. Unit layouts are indicative, not to scale, and subject to change without prior notice. All dimensions, if shown, are approximate and exclude all wall finishes and construction tolerances. Furnishings & accessories shown are for representation only. The final built-up areas may vary from the official measurements issued by the 3rd party survey company accredited by the Dubai Land Department. The developer reserves the right to make any changes on any part of this document if & when they deem necessary.

2-BEDROOM

UNIT 1706 | TYPICAL UNIT TYPE 05B

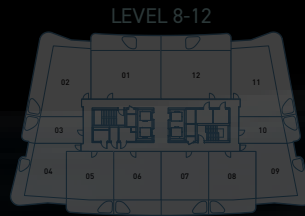
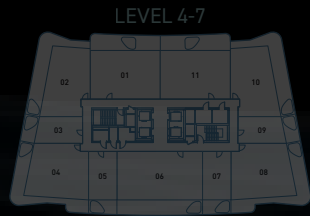

TOTAL AREA

1,208.25 sq.ft.

TOTAL INTERNAL AREA

837.76 sq.ft.

TOTAL EXTERNAL AREA

370.49 sq.ft.



DISCLAIMER

All plans and 3D visualizations are based on conceptual design and are shown for illustration purposes only. Unit layouts are indicative, not to scale, and subject to change without prior notice. All dimensions, if shown, are approximate and exclude all wall finishes and construction tolerances. Furnishings & accessories shown are for representation only. The final built-up areas may vary from the official measurements issued by the 3rd party survey company accredited by the Dubai Land Department. The developer reserves the right to make any changes on any part of this document if & when they deem necessary.

3-BEDROOM APARTMENTS



3-BEDROOM

UNIT 406 | TYPICAL UNIT TYPE 01

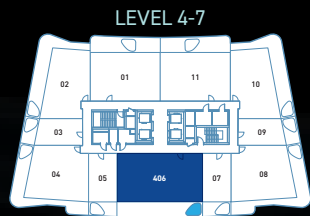

TOTAL AREA

1,631.70 sq.ft.

TOTAL INTERNAL AREA

1,203.51 sq.ft.

TOTAL EXTERNAL AREA

428.19 sq.ft.

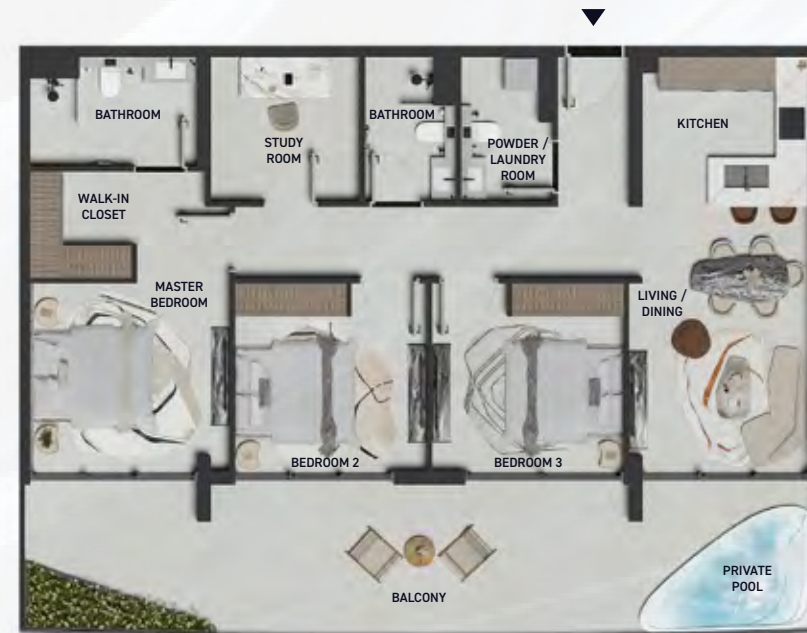

DISCLAIMER

All plans and 3D visualizations are based on conceptual design and are shown for illustration purposes only. Unit layouts are indicative, not to scale, and subject to change without prior notice. All dimensions, if shown, are approximate and exclude all wall finishes and construction tolerances. Furnishings & accessories shown are for representation only. The final built-up areas may vary from the official measurements issued by the 3rd party survey company accredited by the Dubai Land Department. The developer reserves the right to make any changes on any part of this document if & when they deem necessary.

3-BEDROOM

UNIT 1313 | TYPICAL UNIT TYPE 02

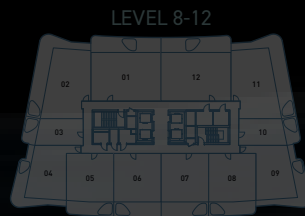
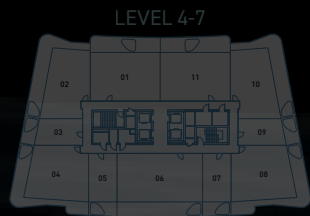

TOTAL AREA

1,587.03 sq.ft.

TOTAL INTERNAL AREA

1,242.48 sq.ft.

TOTAL EXTERNAL AREA

344.55 sq.ft.

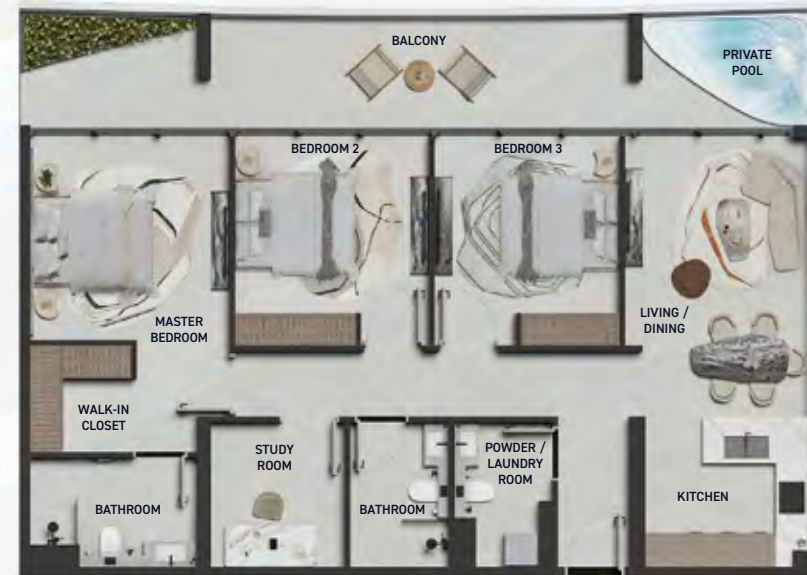

DISCLAIMER

All plans and 3D visualizations are based on conceptual design and are shown for illustration purposes only. Unit layouts are indicative, not to scale, and subject to change without prior notice. All dimensions, if shown, are approximate and exclude all wall finishes and construction tolerances. Furnishings & accessories shown are for representation only. The final built-up areas may vary from the official measurements issued by the 3rd party survey company accredited by the Dubai Land Department. The developer reserves the right to make any changes on any part of this document if & when they deem necessary.



LEOS