

# Takaya Symphony at Motor City

## Typical Floor Plans

### SYMPHONY

Level - 03, 05, 07, 09, 11, 13, 15, 17

UNIT	COUNT
Studio	4 Units
1 Bedroom	6 Units
2 Bedroom	4 Units
3 Bedroom	1 Unit
<b>TOTAL</b>	<b>15 Units</b>

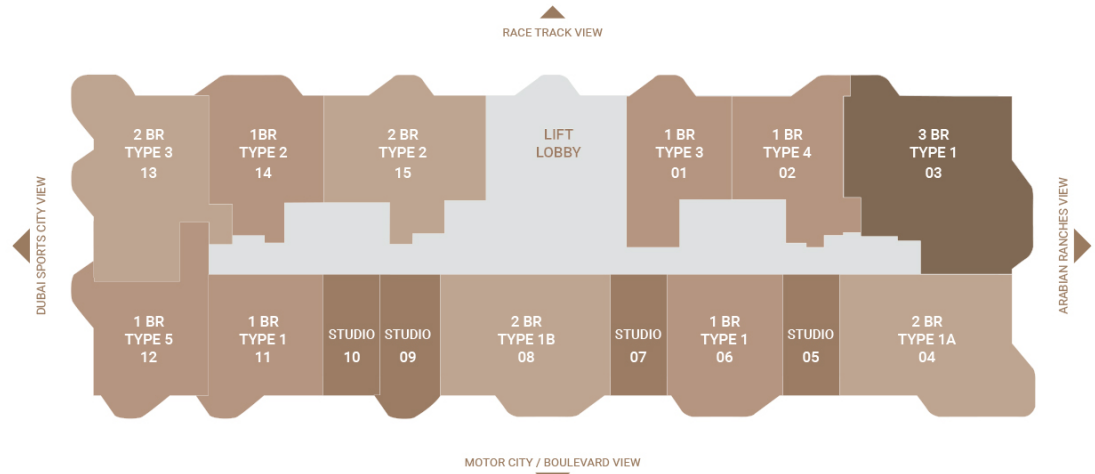

## SYMPHONY

Level - 19

UNIT	COUNT
3 Bedroom	1 Unit
Penthouse	2 Units
Penthouse Duplex	1 Unit
<b>TOTAL</b>	<b>4 Units</b>

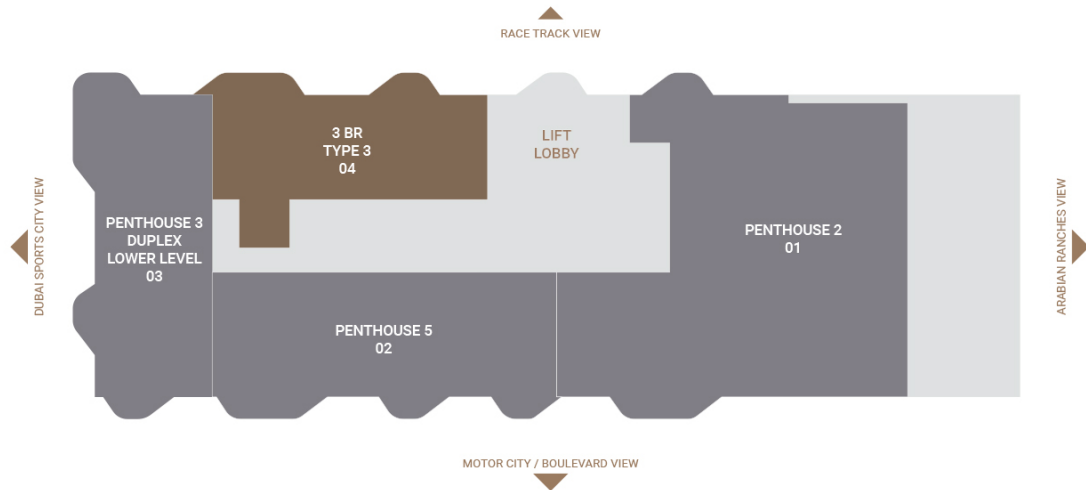

# SYMPHONY

Level - 02

UNIT	COUNT
Studio	4 Units
1 Bedroom	6 Units
2 Bedroom	3 Units
<b>TOTAL</b>	<b>13 Units</b>

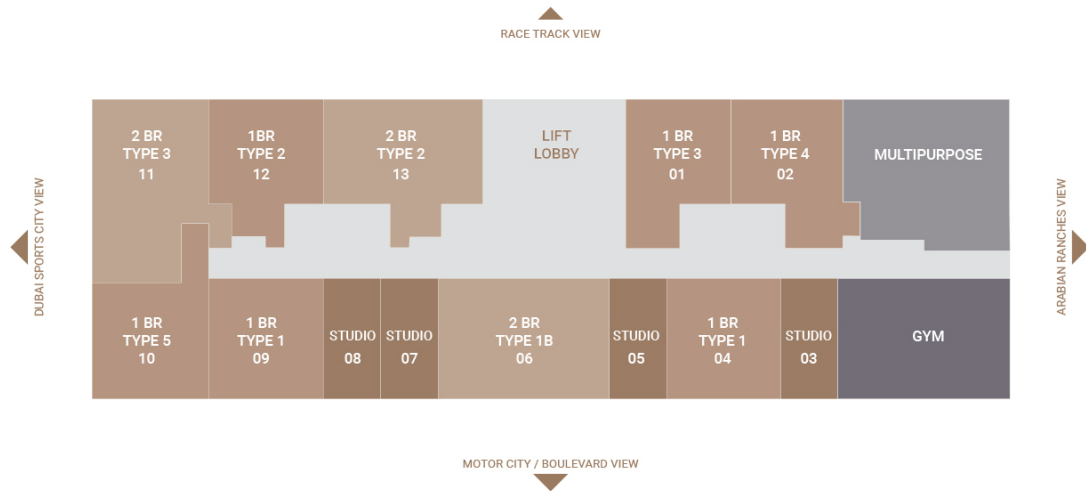

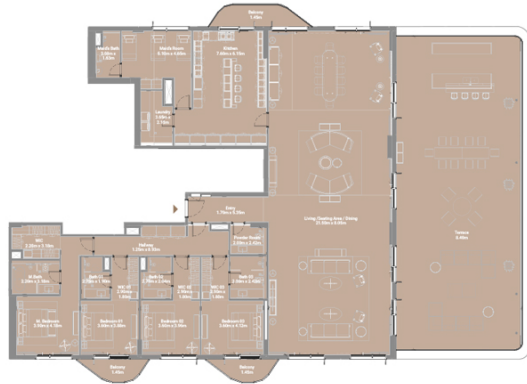

**TYPE 1**

Unit Area	4,578.42 sq.ft
Balcony Area	2,136.42 sq.ft
Total Area	6,714.84 sq.ft

**Keyplan - Level 18**



All images used are for illustrative purposes only and do not represent the actual size, features, specifications, fittings and furnishings. The Developer reserves the right to make revisions / alterations, at its absolute discretion, without any liability whatsoever.

### 1 Bedroom Apartment - Type - 1

Unit Area	788.73 sq.ft
Balcony Area	110.65 sq.ft
Total Area	899.38 sq.ft

Keyplan Level 3 ( Typ. Odd Levels upto L17)

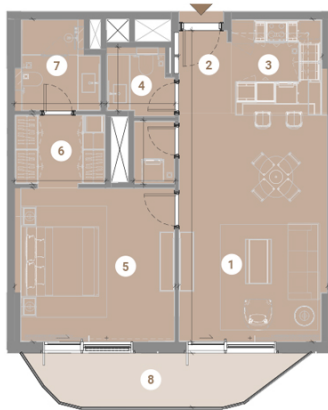
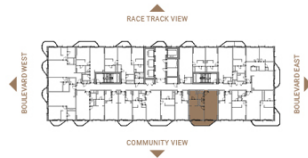

- 1 Living/Dining 6.05m x 3.98m
- 2 Entry 2.25m x 1.30m
- 3 Kitchen 2.57m x 2.58m
- 4 Powder Room 1.70m x 1.83m
- 5 M.Bedroom 4.10m x 4.28m
- 6 WIC 1.85m x 2.43m
- 7 M.Bath 2.45m x 2.30m
- 8 Balcony 1.45m





### TYPE 2

Unit Area	2,972.88 sq.ft
Balcony Area	2,108.22 sq.ft
Total Area	5,081.10 sq.ft

### Keyplan - Level 19

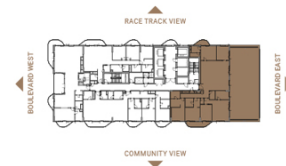

All images used are for illustrative purposes only and do not represent the actual size, features, specifications, fittings and furnishings. The Developer reserves the right to make revisions, alterations, at its absolute discretion, without any liability whatsoever.

### 1 Bedroom Apartment - Type - 2

Unit Area	814.83 sq.ft
Balcony Area	110.65 sq.ft
Total Area	925.48 sq.ft

Keyplan Level 3 (Typ. Odd Levels upto L17)

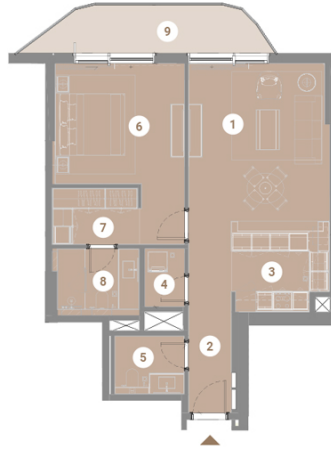
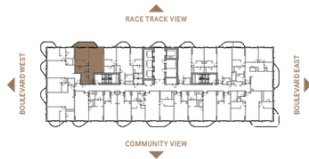

- 1 Living/Dining 4.69m x 4.25m
- 2 Entry 3.60m x 1.30m
- 3 Kitchen 2.70m x 2.95m
- 4 Laundry/Store 1.75m x 1.20m
- 5 Powder Room 1.75m x 2.10m
- 6 M.Bedroom 3.60m x 3.95m
- 7 WIC 1.80m x 2.65m
- 8 M.Bath 2.00m x 2.45m
- 9 Balcony 1.45m



### 1 Bedroom Apartment - Type - 3

Unit Area	796.53 sq.ft
Balcony Area	59.20 sq.ft
Total Area	855.73 sq.ft

Keyplan Level 3 (Typ. Odd Levels upto L17)

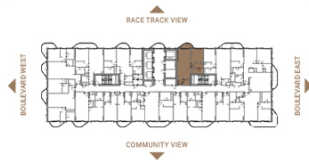

- 1 Living/Dining 6.13m x 4.00m
- 2 Entry 2.15m x 1.40m
- 3 Kitchen 2.70m x 2.40m
- 4 Powder Room 1.75m x 1.85m
- 5 M.Bedroom 3.90m x 3.60m
- 6 WIC 1.75m x 2.25m
- 7 M.Bath 1.65m x 2.90m
- 8 Balcony 1.44m



### 3 Bedroom Apartment - Type - 3

Unit Area	1,786.38 sq.ft
Balcony Area	169.85 sq.ft
Total Area	1,956.23 sq.ft

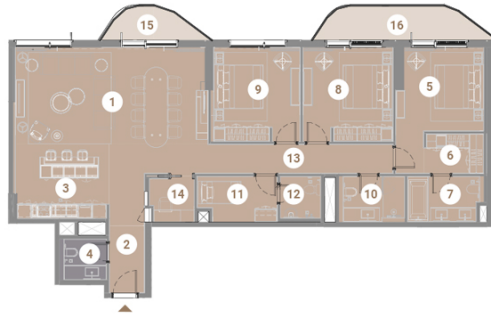

- 1 Living/Dining 4.10m x 8.25m
- 2 Entry 3.75m x 1.50m
- 3 Kitchen 2.62m x 4.05m
- 4 Powder Room 1.75m x 2.00m
- 5 M.Bedroom 3.55m x 3.75m
- 6 WIC 1.80m x 2.45m
- 7 M.Bath 1.95m x 3.25m
- 8 Bedroom 01 4.00m x 3.80m
- 9 Bedroom 02 4.00m x 3.83m
- 10 Common Bath 1.95m x 2.80m
- 11 Maid's Room 1.95m x 3.41m
- 12 Maid's Bath 1.95m x 1.75m
- 13 Hallway 1.25m x 7.83m
- 14 Study 1.85m x 1.93m
- 15 Balcony 1.45m
- 16 Balcony 1.45m

Keyplan Level 18

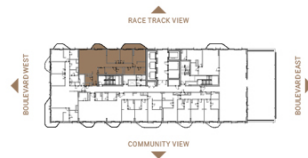

### 1 Bedroom Apartment - Type - 4

Unit Area	851.53 sq.ft
Balcony Area	59.20 sq.ft
Total Area	910.73 sq.ft

Keyplan Level 3 (Typ. Odd Levels upto L17)

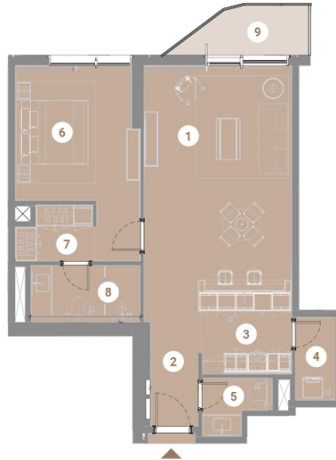
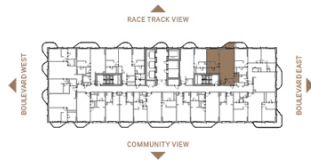

- 1 Living/Dining 6.20m x 4.30m
- 2 Entry 2.10m x 1.40m
- 3 Kitchen 2.70m x 2.70m
- 4 Laundry/Store 2.40m x 1.15m
- 5 Powder Room 1.70m x 2.05m
- 6 M.Bedroom 3.90m x 3.60m
- 7 WIC 1.75m x 2.35m
- 8 M.Bath 1.65m x 3.17m
- 9 Balcony 1.45m



### 1 Bedroom Apartment - Type - 5

Unit Area	860.90 sq.ft
Balcony Area	118.40 sq.ft
Total Area	979.30 sq.ft

Keyplan Level 3 (Typ. Odd Levels upto L17)

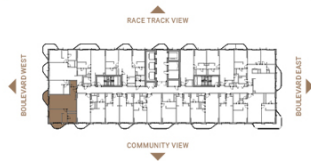

- 1 Living/Dining 4.10m x 5.65m
- 2 Entry 3.60m x 1.80m
- 3 Kitchen 3.50m x 2.50m
- 4 Powder Room 1.85m x 1.80m
- 5 M.Bedroom 4.00m x 3.70m
- 6 WIC 2.75m x 1.73m
- 7 M.Bath 2.65m x 2.50m
- 8 Balcony 1.45m
- 9 Balcony 1.45m



### 2 Bedroom Apartment - Type - 1B

Unit Area	1,181.12 sq.ft
Balcony Area	110.65 sq.ft
Total Area	1,291.77 sq.ft

Keyplan Level 3 (Typ. Odd Levels upto L17)

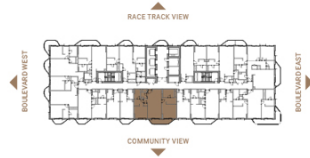

- 1 Living/Dining 5.65m x 4.15m
- 2 Entry 0.75m x 1.30m
- 3 Kitchen 2.72m x 2.85m
- 4 Laundry/Store 0.75m x 1.20m
- 5 Powder Room 1.85m x 1.80m
- 6 M.Bedroom 4.20m x 4.20m
- 7 WIC 1.95m x 3.00m
- 8 M.Bath 2.35m x 3.25m
- 9 Bedroom 01 3.60m x 4.20m
- 10 WIC 01 2.05m x 1.53m
- 11 Bath 01 2.75m x 1.73m
- 12 Balcony 1.45m



Unit Plans - SYMPHONY - PENTHOUSE - TYPE 6.1



TYPE 6.1

Unit Area	2,368.27 sq.ft
Balcony Area	229.06 sq.ft
Total Area	2,597.33 sq.ft

Keyplan - Level 18

